



**Request for Qualifications**  
**University of Nebraska**  
**Kristensen Rural Health Education Complex**



Exterior view of the Kristensen Rural Health Education Complex.

**RFQ Submission Deadline: May 13, 2024**  
**Total Budget: \$150,000**





## Building Description

---

Located on the UNK campus, the Rural Health Education Building addresses a critical need for additional health care professionals in rural communities by allowing more students to study and train in central Nebraska. The new facility — the second facility of the Douglas A. Kristensen Rural Health Education Complex — will bring more health care education opportunities to the University of Nebraska at Kearney campus through expanded health programs administered by the University of Nebraska Medical Center. The \$95 million facility — funded through a public-private partnership — will expand nursing and allied health programs in Kearney, as well as add programs in medicine, pharmacy and public health.

The Rural Health Education Building is a cutting-edge facility that will grow the state's rural health care workforce and help communities thrive. The building will include state-of-the-art classrooms, extensive simulation, and clinical skills laboratories for pre-clinical education and complex clinical scenarios and simulated primary care spaces, administrative and faculty and staff office space to accommodate current and expanded numbers of faculty and staff members, and secure storage space for research and academic records. It will allow UNMC to expand the presence of its allied health and nursing programs in Kearney while launching new programs to train physicians, pharmacists and public health professionals there.

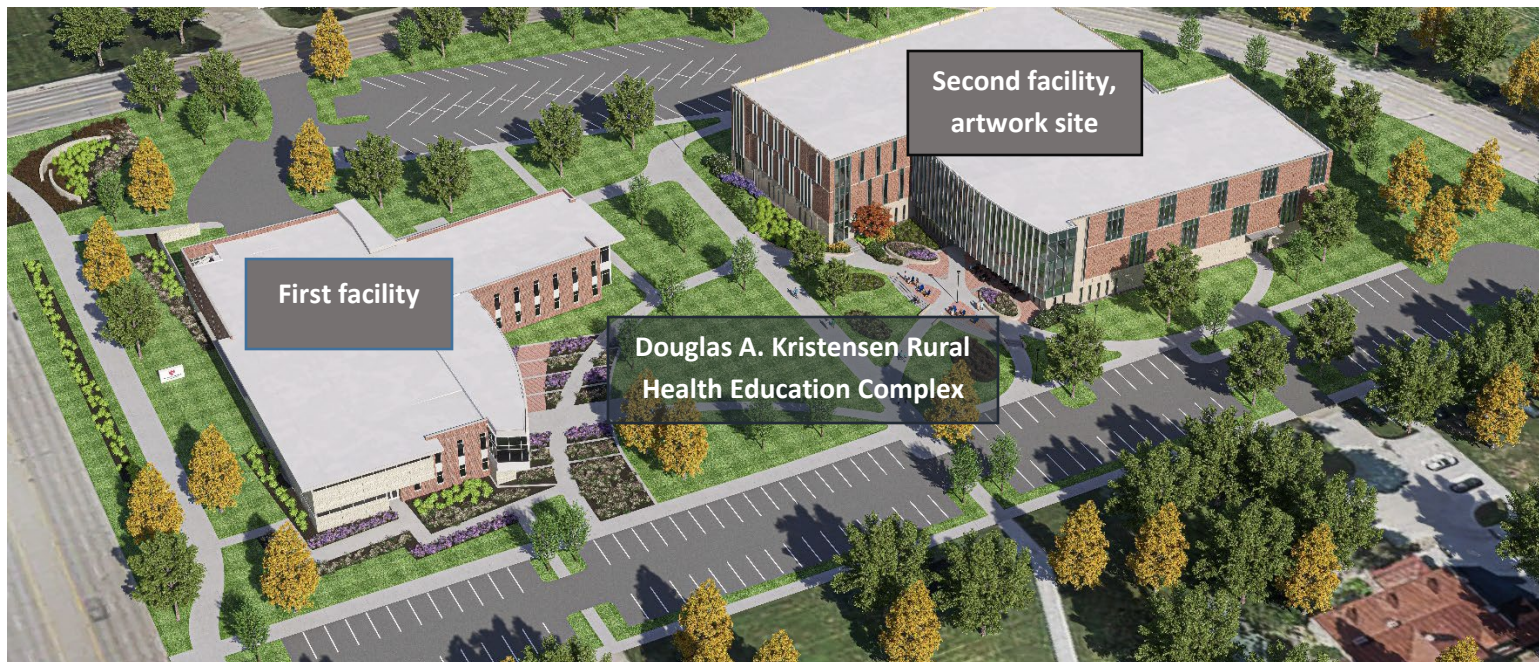

## Artwork Description

---

The design of this new building focuses on the land throughout western Nebraska, the large expanse and soft edges of the topography in the Sandhills. The design first completed project for Nursing was focused on the water that runs through Nebraska. While it does not have to be a literal expression of either healthcare or the Nebraska landscape, the Committee feels that some connection to those elements might lead to a successful and compelling artwork in the new building.

The indoor site of this building is primarily in the large public space on the second floor. The priority for this site are the two walls pictured below, with a possible additional site on the first floor at the base of the staircase. The staircase leads upstairs directly from the main entrance. The artwork for the indoor site will be completed by one artist for the full listed budget, and should create a cohesive experience for this space.

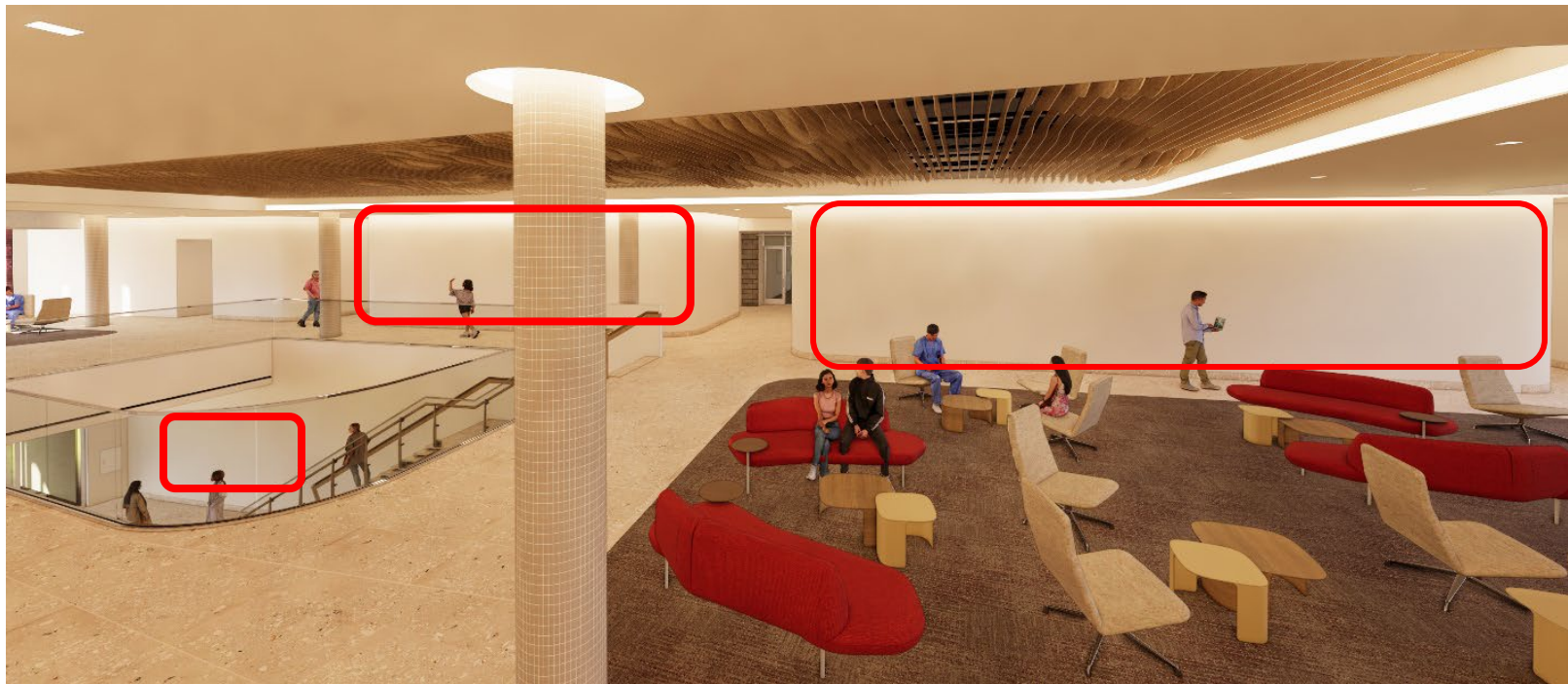

Rendering of new second floor in Kristensen Rural Health Education Complex, view from northeast of the staircase.





Rendering of new second floor in Kristensen Rural Health Education Complex, view from southeast of the staircase.



### Selection Process

The Kristensen Rural Health Education Complex Selection Committee, in consultation with the NAC, has full oversight for the selection of an artist for this project. Professional public artists/teams are eligible who live in the United States. The committee reviews RFQ submissions on SlideRoom. Finalists will receive a presentation honorarium. Presentations will be hosted via zoom, and should include concept, design, detailed budget for the available funds, installation method, projected maintenance.

### Budget

A maximum of \$150,00 is allocated for this project. All expenses for the selected design and commission are the responsibility of the artist/team, including but not limited to: travel/lodging, fabrication and supplies, installation expenses (as needed: engineering, rigging, equipment rental, etc).

### Selection Criteria

Letter of Interest and clarity of conceptual approach. Evidence of skill in artist's material and ability to complete projects from prior artwork.

### Timeline \*subject to change.

March 6, 2024	RFQ posted on SlideRoom
May 13, 2024	RFQ Deadline
May 31, 2024	Finalists notified
Aug 5- 16, 2024	Finalist proposal presentations
August 30, 2024	Selected artist notified
By August, 2025	Artwork installation

### Application Requirements

**Submit materials on SlideRoom:** [nebraska.slideroom.com](https://nebraska.slideroom.com)

### Visual Support Materials

**Image descriptions:** Label each uploaded image with title, medium, year, project budget, and any relevant description.

**Images:** Ten (10) jpg images of completed relevant artworks.

**Video:** Optional video file may demonstrate moving parts, time-based work, functionality, etc. (mov, wmv, or flv files, no larger than 60MB each, nor longer than five minutes each.)

### Required Materials

**CV/Resume:** Limit to three pages.

**Three Professional References:** Complete contact information for references with a deep knowledge of your artwork and work methods, and for which project they worked with you.

**Letter of Interest:** Describe your artistic style, background, relevant past completed projects, and how they relate to this project. If available, provide some description as to how you might use the site. Use 500 words or less.

**Application Fee:** \$10 via the secure payment system on SlideRoom.

### Contact

Meagan Dion, Public Art and Artist Programs Specialist  
Nebraska Arts Council, [meagan.dion@nebraska.gov](mailto:meagan.dion@nebraska.gov)